

360°

EMITTING
LED NEON FLEX

NCR32





Features

- Color options: RGBW
- Adopt RGB+W LEDs, the CCT of white color is changeable.
- Superior design with exquisite craftsmanship ensure stable and reliable performance.
- 360° light-emitting with uniform light.
- 3m running length with one end power feed.
- Can connect to external controller for rich color effects.
- Warranty: 5 years indoor, 3 years outdoor.
- Customization: multiple spec options, can be customized upon requirements.

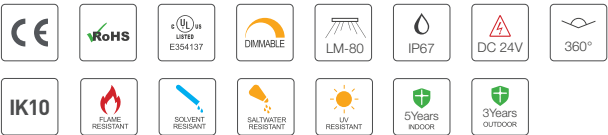

Optical & Electrical Parameters

Model No.	Voltage	Ra	Color	Lm/m	Lm/W	W/m
NCR32-RGBW	24V DC	>90 /	4000K	325	54	6.05
			Red	103	17	6.05
			Green	320	53	6.05
			Blue	53	9	6.05
			RGBW	783	32	24.2
NCR32-RGBW_SPI	24V DC	>90 /	4000K	322	40	8.06
			Red	96	12	8.06
			Green	296	36	8.06
			Blue	58	7	8.06
			RGBW	740	29	25.2

* "RGBW" is the parameter when four chips are all lit.
* NCR32-RGBW_SPI: uses an SPI controller.
* NCR32-RGBW_SPI: IC (UCS2904B) uses the SP105E/MR-502 controller.

Other Parameters

Model No.	LED QTY (pcs/m)	Standard Run	Pixel	Working Temperature	Storage Temperature
NCR32-RGBW	336	3000mm	--	-20~+60°C	-20~+70°C
NCR32-RGBW_SPI	336	3000mm	7Pix/m	-20~+60°C	-20~+70°C

Profile Drawings

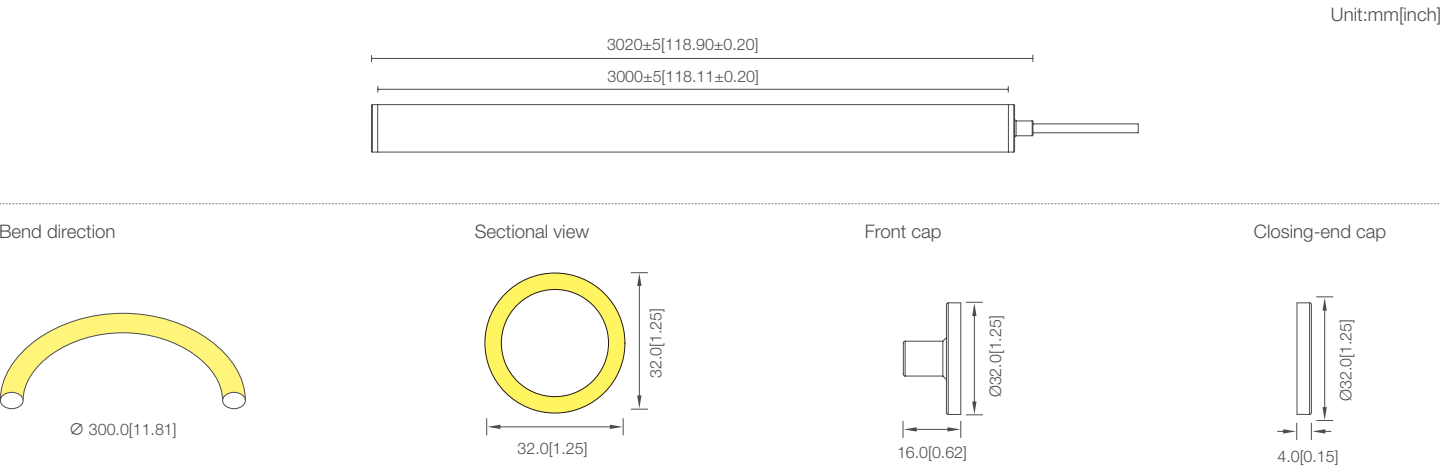

Luminous Intensity Distribution Diagram

Average Illumination

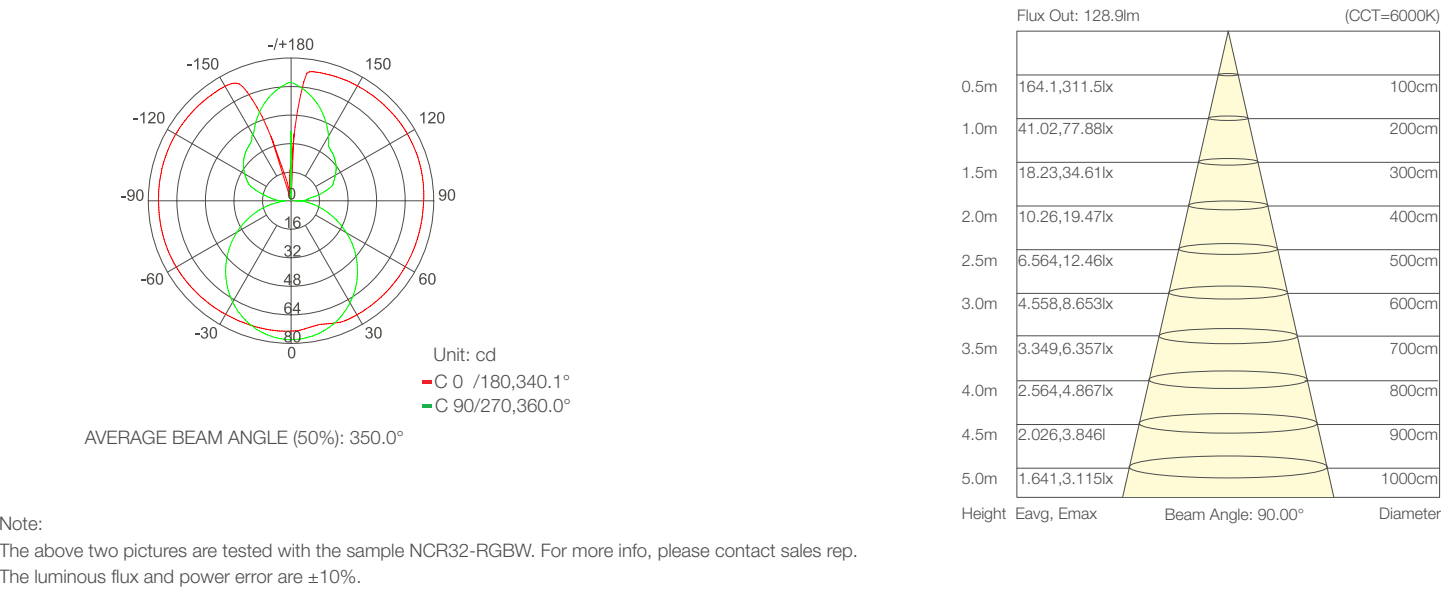

Recommended power supply upon working length

NCR32-RGBW					
Working Length	Measured Current	Rated Voltage	Measured Power	Recommended Power Supply	Power Supply Mode
1m	1.00 A	24V DC	24.0 W	40 W	Single Feed
3m	2.70 A	24V DC	64.8 W	80 W	Single Feed

NCR32-RGBW_SPI					
Working Length	Measured Current	Rated Voltage	Measured Power	Recommended Power Supply	Power Supply Mode
1m	1.03 A	24V DC	24.72 W	40 W	Single Feed
3m	2.80 A	24V DC	67.2 W	80 W	Single Feed

Products and Tools

LED power supply

Electric drill

Controller (If needed)

Product accessories

ASY-NCR32-N00NNH-EC

Item: Front cap

Dimensions L*W*H: $\varnothing 32*16\text{mm}$

Quantity (3m): 2pcs

Free/Optional: Optional

ASY-NCR32-N00NNX-EC

Item: Closing End-cap

Dimensions L*W*H: $\varnothing 32*4\text{mm}$

Quantity (3m): 2pcs

Free/Optional: Optional

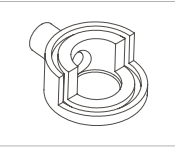

ASY-NCR32-N00NNS-EC	
Item:	Front cap (side outlet)
Dimensions L*W*H:	41*32*15mm
Quantity (3m):	--
Free/Optional	Optional

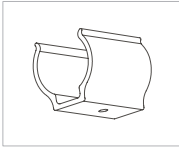

ASY-NCR32-P1NN0020-MT	
Item:	Plastic groove-20mm
Dimensions L*W*H:	20*37*36.6mm
Quantity (3m):	--
Free/Optional	Optional

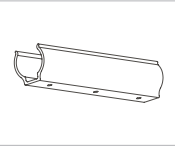

ASY-NCR32-P3NN1000-MT	
Item:	Plastic groove-1000mm
Dimensions L*W*H:	1000*37*36.6mm
Quantity (3m):	--
Free/Optional	Optional



WR-7516	
Item:	Silicone Glue
Dimensions:	45g/pc
Quantity (3m):	--
Free/Optional	Optional



PA3	
Item:	Screws
Dimensions L*W*H:	PA3*10mm
Quantity (3m):	--
Free/Optional	Optional

Profile Drawings (neon + installation accessories)

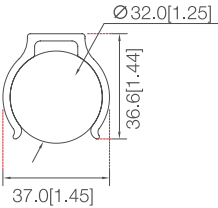

Plastic groove
ASY-NCR32-P1(P3)NNXXXX-MT

Installation

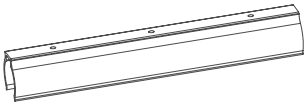

Prepare the plastic groove

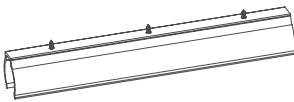

Use screws to fix the plastic groove to the mounting surface

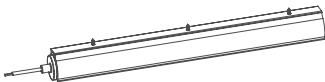

Put the strip into the groove



Note:
The profile must be installed vertically and securely fastened, as shown in the diagram above. Customers should choose the appropriate installation steps based on their actual needs. During the installation process, please ensure that the minimum bending diameter is met at corners. Please use our company's matching accessories for installation to avoid unnecessary damage. For more information, please contact sales rep.

Controller wiring diagram

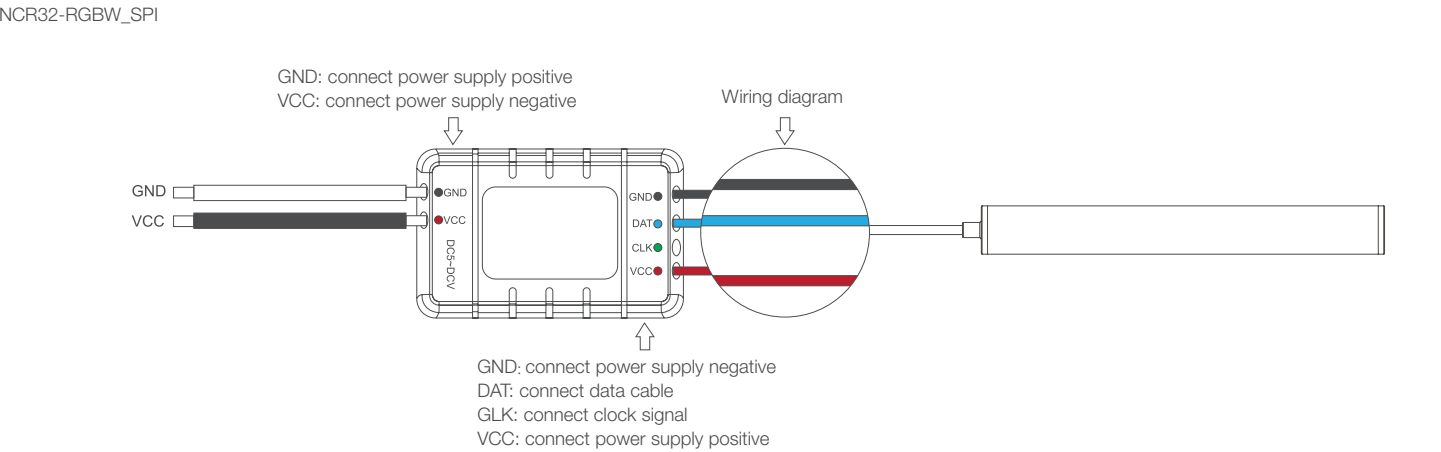
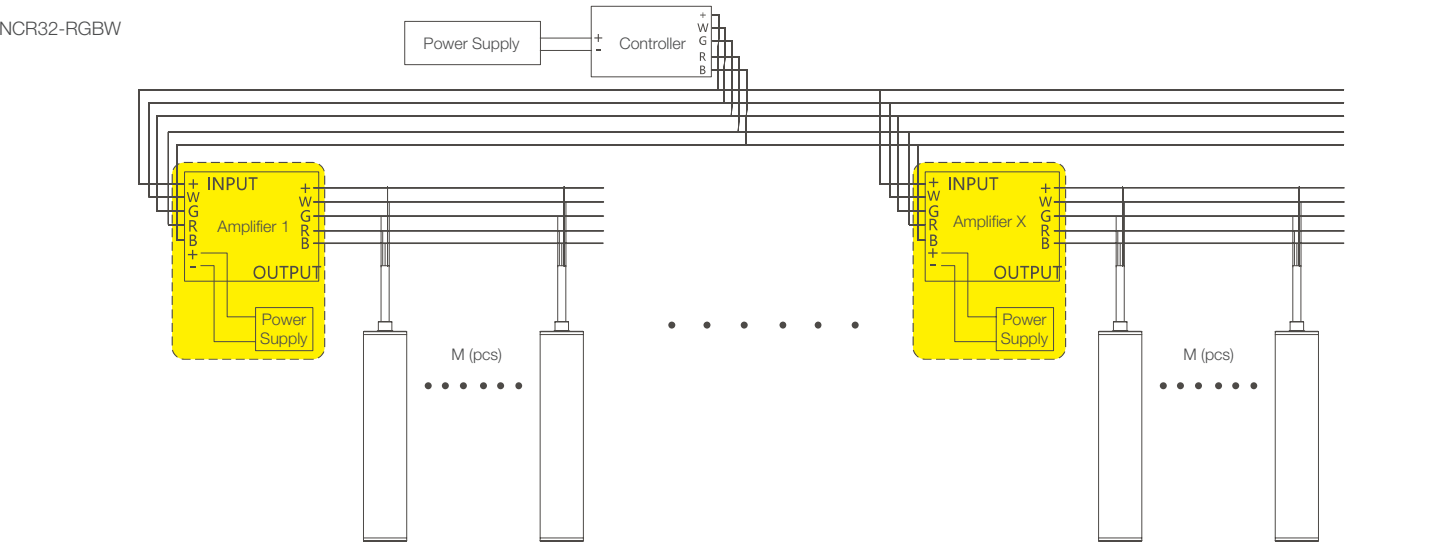

- Notes:
- 1. The case uses the SP105E pixel controller;
 - 2. The controller supports Bluetooth and mobile phone APP control;
 - 3. Bluetooth control distance is 20m;
 - 4. SP105E can drive up to 2048 pixels;
 - 5. Controller AP105E working voltage DC5~24V;
 - 6. For other information, see the SP105E Illusion Manual. SP105E recommends a load of less than 50m;

Packaging Information

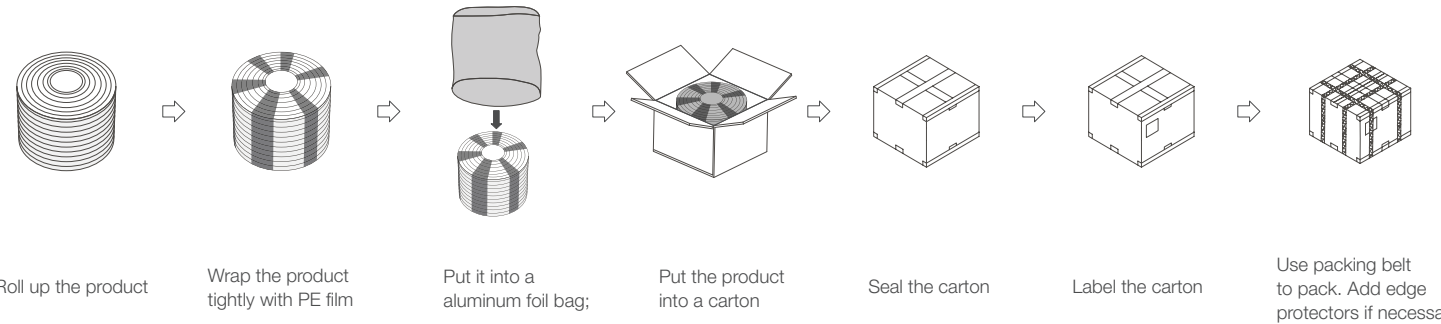

Packaging information

Model No.	Product Size (mm)	Carton Size (mm)	Meter/Reel	Reel/Carton	Gross Weight (kg)
NCR32	3000*32*32	455*455*250	3	10	16.50(1± 10%)

Note:

- For other customized length packaging, please ask our sales rep.
- The above-mentioned packaging quantity and weight are only for the illustrated packaging method. For other packaging methods, the packaging quantity and weight will be different. The actual weight is subject to the actual product.

Reliability test

Project	Reference standards	Category	Test conditions	Outcome
Environmental test	Blueview standard	PTC test	TH=-40~+60°C/ 2h, dwell 15min, temperature rise/down takes 45min.	Pass
		High temperature resistance test	Simulated TH=60°C, continuously light on	
		UV test	UVB wavelength: 315-400nm; radiation intensity: 0.83W/m² TH=50°C/ 5h; spray 1h	
		Room temperature aging test	Ta=25°C, continuously light on	
		IK10 test	Impact ball weight :1.7kg, impact energy :20J, impact ball Elevation:1.2m(=20J/1.7kg*9.8m/s)	
		IPX7	soaking depth 1m, test duration 30min	IP67
Mechanical strength testing	Blueview standard	Tensile test	Both ends of the strip fixed on the testing equipment. then power on and record the tension value when the sample is turned off.	Pass
		Lifting test	Fix the sample on the mounting clip, place down the side mounted with strip for 1h, and observe whether the strip falls off.	

Warning Mark

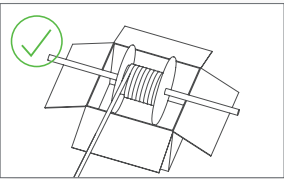

Insert a stick on the reel and place it on the packing box, and rotate the reel to get the product.

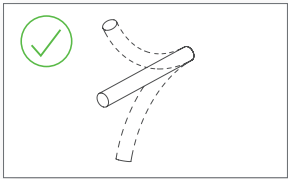

Correct usage

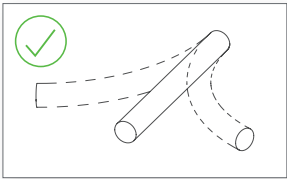

Correct usage

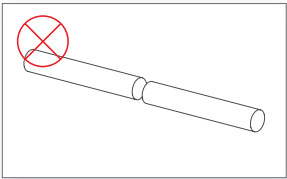

Do not make cuts.

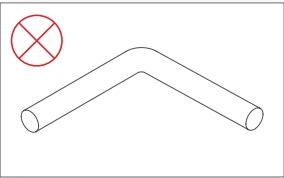

Do not bend at right angles

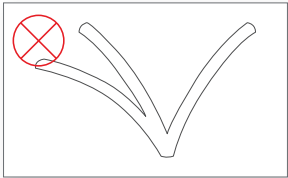

Do not bend many times, for it can endanger electronic lines.

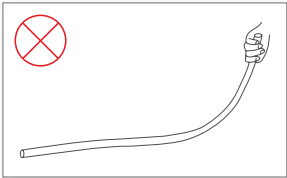

Do not throw or pull when taking products

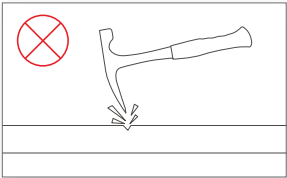

Avoid touching sharp objects

Note:

Please pay attention to above warnings when using;

Our company will not be held responsible for any quality hazards caused by damage to the product due to contact with sharp objects.

Warning

- Do not disassemble or retrofit the light. Do not touch the surface of the light with a sharp object.
- Do not do live-line working during installation, especially for high voltage product.
- Do not use any organic chemical solvents.
- Use neutral glass adhesive to fix this product and it needs to be dried 4 hours in the open environment after operation.
- Treat the ends and the circuit connection points that are not connected to the main line with insulation, waterproof, and anti-corrosion in the installation.
- Use 18AWG (0.75mm² cross-sectional area) or thicker core wire to avoid adverse consequences caused by overheating, if the power cable need to lengthen.
- Make sure the input voltage meets the requirements and lines are connected correctly before lighting on
- This product is for signage, and do not use as general lighting.
- Series connection within the max run.
- The length of the power cable between the power supply and the led strip should not exceed 2 meters. Otherwise, large circuit loss will lead to inconsistent brightness.
- Installation, maintenance and repair should be operated by a qualified technician.

Attentions before installation

- Before installation, check that the product parameters are consistent with the requirements (Seeing product specifications or product labels)
- Load voltage, current, power and power supply should be matched with the product.
- Follow the instructions of wiring diagram (first connect the load and then the power supply) to avoid short circuit
- Make sure the correct connection of positive and negative poles between products and power supply. Otherwise, the light will not be on.
- Make sure the power cord firmly screwed into the terminal and it should not be pulled out by hands.
- The terminal should have waterproof and anti-corrosive treatment.

Statements and Recycling

Packaging information

- Repair should be operated by a qualified technician or supplier, if the external circuit or main line of this product is damaged.
- The parameters given in this manual are typical values and for reference only
- All illustrations and drawings in this manual are for reference.
- This product is subject to change without notice.

Recycling

- LED lighting products belongs to electronic products, please do recycling treatment according to the relevant WEEE directives.

Version	Content	Date
A1.0	First release	2023-8-4